



PORTABLE COMPRESSOR

RACCV8B

USER GUIDE

WARNING: Read thoroughly the instruction manual before using.

CONTENTS

1. SAFETY INSTRUCTIONS.....	3
2. YOUR PRODUCT.....	7
3. OPERATION.....	9
4. MAINTENANCE AND STORAGE.....	11
5. TROUBLESHOOTING.....	12
6. DISPOSAL.....	12
7. DECLARATION OF CONFORMITY.....	13
8. WARRANTY.....	14
9. PRODUCT FAILURE.....	15
10. WARRANTY EXCLUSIONS.....	16

1. SAFETY INSTRUCTIONS

GENERAL POWER TOOL SAFETY WARNINGS

 **WARNING:** Read all safety warnings, instructions, illustrations and specifications provided with this power tool. *Failure to follow all instructions listed below may result in electric shock, fire and/or serious injury.*

Save all warnings and instructions for future reference.

The term "power tool" in the warnings refers to your mains-operated (corded) power tool or battery-operated (cordless) power tool.

1) Work area safety

- a) **Keep work area clean and well lit.** *Cluttered or dark areas invite accidents.*
- b) **Do not operate power tools in explosive atmospheres, such as in the presence of flammable liquids, gases or dust.** *Power tools create sparks which may ignite the dust or fumes.*
- c) **Keep children and bystanders away while operating a power tool.** *Distractions can cause you to lose control.*

2) Electrical safety

- a) **Power tool plugs must match the outlet. Never modify the plug in any way. Do not use any adapter plugs with earthed (grounded) power tools.** *Unmodified plugs and matching outlets will reduce risk of electric shock.*
- b) **Avoid body contact with earthed or grounded surfaces, such as pipes, radiators, ranges and refrigerators.** *There is an increased risk of electric shock if your body is earthed or grounded.*
- c) **Do not expose power tools to rain or wet conditions.** *Water entering a power tool will increase the risk of electric shock.*
- d) **Do not abuse the cord. Never use the cord for carrying, pulling or unplugging the power tool. Keep cord away from heat, oil, sharp edges or moving parts.** *Damaged or entangled cords increase the risk of electric shock.*
- e) **When operating a power tool outdoors, use an extension cord suitable for outdoor use.** *Use of a cord suitable for outdoor use reduces the risk of electric shock.*
- f) **If operating a power tool in a damp location is unavoidable, use a residual current device (RCD) protected supply.** *Use of an RCD reduces the risk of electric shock.*

3) Personal safety

- a) **Stay alert, watch what you are doing and use common sense when operating a power tool. Do not use a power tool while you are tired or under the influence of drugs, alcohol or medication.** *A moment of inattention while operating power tools may result in serious personal injury.*
- b) **Use personal protective equipment. Always wear eye protection.** *Protective equipment such as a dust mask, non-skid safety shoes, hard hat or hearing protection used for appropriate conditions will reduce personal injuries.*
- c) **Prevent unintentional starting. Ensure the switch is in the off-position before connecting to power source and/or battery pack, picking up or carrying the tool.** *Carrying power tools with your finger on the switch or energising power tools that have the switch on invites accidents.*
- d) **Remove any adjusting key or wrench before turning the power tool on.** *A wrench or a key left attached to a rotating part of the power tool may result in personal injury.*
- e) **Do not overreach. Keep proper footing and balance at all times.** *This enables better control of the power tool in unexpected situations.*
- f) **Dress properly. Do not wear loose clothing or jewellery. Keep your hair and clothing**

away from moving parts. *Loose clothes, jewellery or long hair can be caught in moving parts.*

- g) **If devices are provided for the connection of dust extraction and collection facilities, ensure these are connected and properly used.** *Use of dust collection can reduce dust-related hazards.*
- h) **Do not let familiarity gained from frequent use of tools allow you to become complacent and ignore tool safety principles.** *A careless action can cause severe injury within a fraction of a second.*

4) Power tool use and care

- a) **Do not force the power tool. Use the correct power tool for your application.** *The correct power tool will do the job better and safer at the rate for which it was designed.*
- b) **Do not use the power tool if the switch does not turn it on and off.** *Any power tool that cannot be controlled with the switch is dangerous and must be repaired.*
- c) **Disconnect the plug from the power source and/or remove the battery pack, if detachable, from the power tool before making any adjustments, changing accessories, or storing power tools.** *Such preventive safety measures reduce the risk of starting the power tool accidentally.*
- d) **Store idle power tools out of the reach of children and do not allow persons unfamiliar with the power tool or these instructions to operate the power tool.** *Power tools are dangerous in the hands of untrained users.*
- e) **Maintain power tools and accessories. Check for misalignment or binding of moving parts, breakage of parts and any other condition that may affect the power tool's operation. If damaged, have the power tool repaired before use.** *Many accidents are caused by poorly maintained power tools.*
- f) **Keep cutting tools sharp and clean.** *Properly maintained cutting tools with sharp cutting edges are less likely to bind and are easier to control.*
- g) **Use the power tool, accessories and tool bits etc. in accordance with these instructions, taking into account the working conditions and the work to be performed.** *Use of the power tool for operations different from those intended could result in a hazardous situation.*
- h) **Keep handles and grasping surfaces dry, clean and free from oil and grease.** *Slippery handles and grasping surfaces do not allow for safe handling and control of the tool in unexpected situations.*

5) Service

- a) **Have your power tool serviced by a qualified repair person using only identical replacement parts.** *This will ensure that the safety of the power tool is maintained.*
- b) **Always arrange for the exchange of the plug or the power cord to be carried out by the manufacturer of the appliance or by its approved customer services.** *This will ensure that the safety of the power tool is maintained.*

SPECIAL SAFETY INSTRUCTIONS

- This appliance may not be used by children or people with reduced physical, sensory or mental capabilities or a lack of experience and knowledge. Children must not use the appliance as a plaything. Cleaning and user maintenance tasks may not be carried out by children.
- Avoid using the compressor at temperatures below +5 degrees.
- Never leave the compressor unsupervised while it is in use.
- Ensure that the ON/OFF switch is turned off when connecting to the mains power supply.
- Caution! Operate the compressor only for a short time. The appliance may overheat if operated continuously for longer than 10 minutes. Switch the appliance off immediately and allow it to cool down for at least 10 minutes.
- Risk of injury! Do not pump any objects up to more than the intended pressure. They could burst

and cause injury and/ or material damage.

- Do not exceed the permissible output range of the compressor. Do not pump up any lorry, tractor or other large tires.
- Do not work with any materials that are or could be easily inflammable or explosive.
- Never use the appliance for purposes other than the ones for which it was designed
- The appliance must always be kept clean, dry and free from oil or grease.
- Never use gasoline or other inflammable liquids to clean the unit! vapour remaining in the appliance could be ignited by sparks and lead to the explosion of the appliance!
- Remain alert at all times! Never use the appliance when you are distracted or don't feel well. Safety instructions for working with compressed air and blow-out guns.
- The compressor and hoses can get very hot during operation. Touching them can cause burns.
- The gas or vapour sucked in by the compressor intake must be kept free of admixtures that could lead to fires or explosions inside the compressor.
- When removing the hose coupling, always hold the hose coupling firmly to avoid injury caused by the hose flying off.
- When working with the blow-out gun, wear goggles. Foreign bodies and blown out particles can easily cause injuries.
- Do not direct the blow-out gun at people or use it to clean clothing you are wearing.
- Check all connections and supply lines. All maintenance units, couplings and hoses must correspond to the appliance parameters in terms of pressure and air flow. Excessively low pressure will adversely affect the function of the appliance; excessively high pressure can cause property damage and personal injury. Protect the hoses against kinking, constriction, solvents and sharp edges.
- Ensure that the hose clamps are always tight. Loose or damaged hose clamps can allow air to escape in an uncontrolled manner.
- Replace a damaged hose immediately. A faulty supply line can cause a compressed air hose to thrash about and cause personal injury.
- Do not breathe in the exhaust air directly.
- The hose must be designed for at least 150% of the maximum pressure generated in the system.
- Ensure the secure footing and stable positioning of the compressor. During operation the compressor shall always be placed on its rubber feet or the bottom side.
- Never exceed the inclination angle of 15° (vertical position) or 15° (horizontal position).
- The tool and the supply hose must be fitted with a hose coupling that allows the pressure of the coupling hose to be dispersed completely during disconnection.
- **WARNING!** An undersized compressed air system will reduce the efficiency of your appliance. Avoid getting exhaust air in your eyes. The exhaust air from the appliance may contain water, oil, metal particles or impurities from the compressor. This can cause damage to health.
- **WARNING!** Take care when putting down the appliance! Always put the appliance down so it does not lie on the ON/OFF switch (1). Under certain circumstances, this could cause an accidental activation of the appliance which, in turn, could lead to hazards.
- The user has to make provision for the installation of the over-current protection of the power circuit. The installation must be made according to the norm EN60204.
- In all areas accessible to personnel the concentration of processed gases that can displace breathing air shall be kept within acceptable levels.
- User shall refer to the norm EN 12021 for acceptable levels of contaminants in breathing air;
- Always proceed to pressure relief valve maintenance and testing at regular intervals to confirm their correct operation at their specified setting.
- All hoses and fittings shall be suitable for site use at the maximum allowable pressure of the portable compressors;
- Where a parking brake is not fitted the use of wheel chocks is recommended when parked and

in use. Always transport the tool by its handle. The tool shall be switched off and cold before transportation.





RESIDUAL RISKS







- Even if the device is used according to instructions, it's impossible to eliminate all the risks associated with its operation. The following risks may occur arising from device construction:
- Electrical hazard caused by touch with live parts (direct contact) or with parts, which came under a voltage due to failure of the device (indirect contact).
- Heat hazard resulting in burning or scalding and other injuries caused by possible contact with high temperature objects or materials including heat sources.
- Dangers caused by contact with harmful liquids, gas, mist, smoke and dust or by their inhalation (for example breathing in).
- Dangers caused by failing in ergonomic principles by construction of the machine, for example dangers caused by unhealthy position of body or excessive overcharge and unnature to the anatomy of the human hand-arm, relate to construction of handle, equilibrium of the machine.
- Dangers caused by unexpected starting, unexpected exceeding of motor revs caused by defect/failure of control system, relate to the defects by the handle and placing of drivers.
- Dangers caused by impossibility to stop the machine in best conditions, relate to solidity of the handle and placing of motor shut down device.
- Dangers caused by defect of machine control system, relate to solidity of the handle, placing of drivers and marking.
- Dangers caused by shooting up of subjects or splashing of liquids.
- Mechanical hazard, caused by cut and throw off.
- Noise risk resulting in loss of hearing (deafness) and other physiological disorders (e.g. loss of balance, loss of consciousness).
- Vibration risk (resulting in vascular and neurological harm in the hand-arm system, for example so called "white finger disease").
- The product produces an electromagnetic field of a very weak intensity. This field may interfere with some pacemakers. To reduce the risk of serious or fatal injury, persons with pacemakers should consult the use with their physician and the manufacturer.

Intended use

This applicable is designed for inflating, bicycle tires, inflatable mattresses, sport balls, inflatable dinghies, etc. in conjunctions with the supplied adapter. Any other usage of or modification to the appliance is deemed to be improper and carries significant risk of accidents. The manufacturer accepts no responsibility for damage(s) resulting from improper usage. The appliance is not intended for commercial use.

Explanation of Symbols

	<p>This product complies with the European directives and an evaluation method of conformity for these directives was done.</p>
	<p>This product should not be disposed of in domestic waste. Please contact your local recycling centre for disposal service.</p>
	<p>Class II tools symbol.</p>
	<p>Read operator's manual.</p>

	Do not expose to rain.
	Wear ear protection.
	This product is suitable for indoor use.
	Warning: Electricity. Risk of electrical shock.
	Warning: Compressor unit may start without warning.
	Warning: Exhaust of hot or harmful gases in normal working area.
	Warning: risk of high temperature!

2. YOUR PRODUCT

a. Description



1	Storage area for adapter/nozzles	8	Large universal adapter	15	Pneumatic gun
2	Power cord storage	9	Blowing adapter-needle	15A	Gun pressure hose
3	Air inlet	10	Needle to inflate balls	15B	Trigger
4	Handle	11	Small universal adapter	15C	Pressure gauge
5	ON/OFF switch	12	Presta/Dunlop valve adapter	15D	Drain valve

6	Pressure hose storage area	13	Nozzle adapter	15E	Air gun quick coupler
7	Compressor pressure hose	14	Big nozzle		

b. Illustrated guide

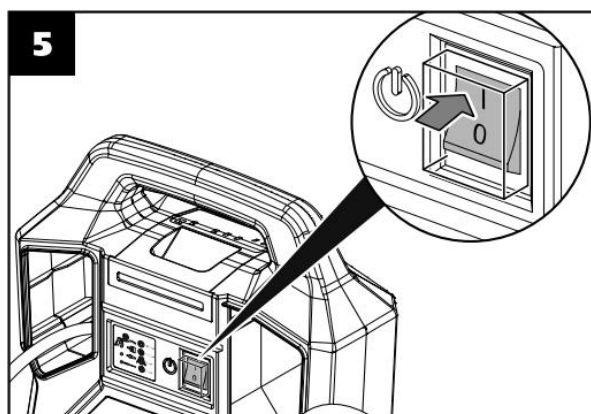
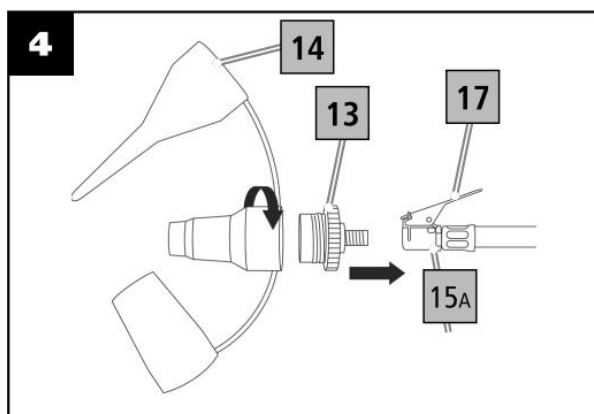
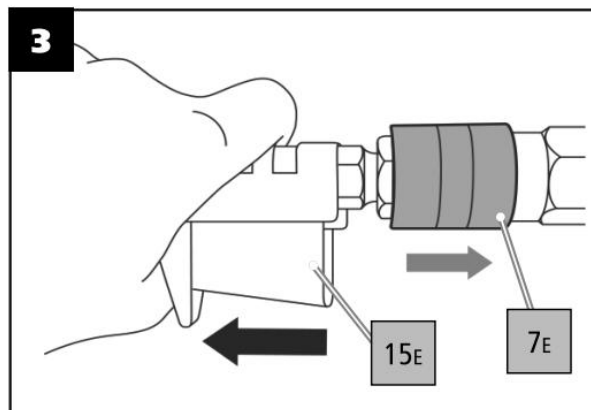
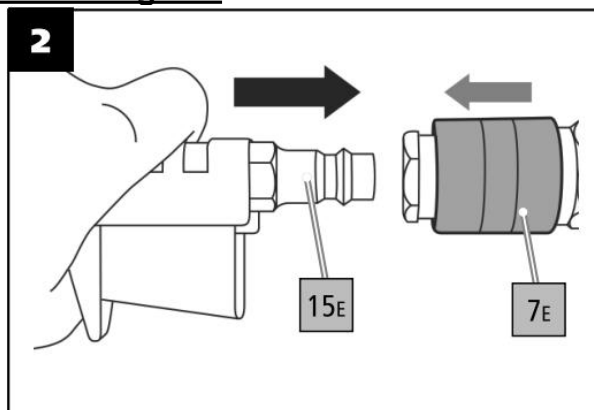

c. Technical specifications

Model	RACCV8B
Rated Voltage & Frequency	230V~ 50Hz
Rated power	1.1kW
Operating mode	S3 15% 10min
Compressor speed	3550/min
Operation pressure	Max. 8bar
Theo. Intake capacity	180l/min
Protection rating	IP20
Protection class	II/□
Weight	6.5kg
Sound pressure level	LpA: 83dB(A) K=3 dB(A)
Sound power level	LwA: 94dB(A) K=3 dB(A)

The sound values have been determined according to noise test code given in EN 1012-1, using the basic standard EN ISO 2151.

The sound intensity level for the operator may exceed 80 dB(A) and ear protection measures are necessary.

– the declared noise emission value(s) have been measured in accordance with a standard test method and may be used for comparing one tool with another;

– the declared noise emission value(s) may also be used in a preliminary assessment of exposure.

Warning:

- that the noise emissions during actual use of the power tool can differ from the declared values depending on the ways in which the tool is used especially what kind of workpiece is processed; and
- of the need to identify safety measures to protect the operator that are based on an estimation of exposure in the actual conditions of use (taking account of all parts of the operating cycle such as the times when the tool is switched off and when it is running idle in addition to the trigger time).

3. OPERATION

CONDITIONS OF USE

This product is exclusively intended for the use:

- For generating compressed air for tools operated by compressed air. Your new air compressor can be used for inflating tires, balls, plastic toys, etc. In most of these applications is needed to set up the compressor
- For private use only
- According to the corresponding descriptions and safety instructions in these operating instructions.
- Any other use is not as intended.

UNPACKING

- Carefully check all parts after unpacking the product from the box.
- Do not throw away packaging materials until you have not reviewed carefully if they did not remain a part of the product.
- Parts of the packaging (plastic bags, paper clips, etc.) do not leave within reach of children, could be a possible source of danger. There is a danger of swallowing or suffocating!
- If you notice any damage during transport or unpacking, notify your supplier immediately. **DO NOT PUT INTO OPERATION.**
- We recommend save the package for future use. The packaging materials must still be recycled or disposed of in compliance with the relevant legislation. Sort different parts of the packaging according to material and hand it to the appropriate collection sites. For further information contact your local administration.

NOTE: Fasteners can become loose during transport in the packaging.

BEFORE STARTING THE MACHINE

 **WARNING! PLEASE READ THE OPERATING INSTRUCTIONS!** Read all instructions before operation. Pay special attention to safety instructions.

TRAINING

NOTE: All operating personnel must be adequately trained in the use, operation and setting and especially familiar with prohibited activities.

 **CAUTION!**

- Never allow use by children or people unfamiliar with these instructions.
- This product is not intended for use by persons with reduced sensory or mental capacity or lack of experience and knowledge - unless they are under the supervision of the person responsible for their safety or if this person has instructed how use this product. The product is not intended for use by children and persons with reduced mobility or poor physical disposition. We strongly recommend to pregnant women to contact her doctor before use of this product.
- The use of other accessories or attachments other than those specified in the instructions for use, can cause injury.



WARNING! All installation, dismantling, cleaning and maintenance should only be done with the appliance disconnected from the mains.

PRIOR TO STARTING

- Make sure the compressor is right for the job.
- Never inflate items that require more pressure than the equipment's maximum pressure.
- Make sure that the equipment's ventilated openings remain clear
- Remove adapters/nozzles, connection cable and pressure hose from storage areas
- Place all necessary components and the compressor on a flat surface.

PNEUMATIC GUN(Fig 4)

- The pneumatic gun is suitable for direct use with auto-valves that can be connected directly to the end of the gun hose [15A].
- The pneumatic gun can also be used to inflate other objects with the help of the included nozzles and adapters.

CONNECTING AND DISCONNECTING THE PNEUMATIC GUN(Fig 1-3)

- Remove compressor pressure hose [7] and air gun [15] from pressure hose compartment [6].
- Slide the plug of the gun quick coupling stem [15E] into the mating part on the compressor pressure hose [7] and push the two couplings together (until you hear them click).
- When disconnecting the gun [15], first turn the compressor off, disconnect it and blow the air out of the hose.
- Pull the quick-coupling retaining ring onto the hose and pull the quick-coupling onto the gun.

NOZZLES AND ADAPTERS CONNECTION(Fig 1, 4)

- Adapters can be connected directly to the end of the gun's pressure hose (after lifting the lever).
- Can be connected to the air gun hose
- Large universal adapter [8] - for various uses
- Ball inflation needle [10] - to inflate all kinds of balls
- Small universal adapter [11] - e.g. to inflate mattresses
- Presta/Dunlop valve adapter [12] - to inflate bicycles tyres
 - Nozzle adapter [13] into which one of the three large nozzles [14] can be inserted
 - A. Conical universal nozzle
 - B. Auto valve nozzle
 - C. Nozzle for standard valves with an internal diameter of 8 mm or larger

You must slide these nozzles onto the large universal adapter [13] that connects to the end of the gun's pressure hose.

BLOWER ADAPTER CONNECTION

The blower adapter is designed to remove dust and dirt from hard-to-reach places.

ASSEMBLY

- Disconnect the air gun from the compressor
- Remove the hose from the air gun with a wrench. (In an anti-clockwise direction.)
- Fit the blower adapter into the thread and tighten it with a wrench (in a clockwise direction).
- Connect the air gun to the compressor hose

NOTE: When connecting and disconnecting accessories, be careful not to get dirt into the connections. Dirt can cause assembly problems and joint leaks.

OPERATION(FIG 5)

- Only use the compressor in dry, well ventilated rooms. The room must be free from dust, acids, fumes, explosive or flammable gasses.
- Check that all of the device's parts are in perfect condition.
- Make sure that the available mains voltage is compatible with the voltage intended for operating the compressor.

- Connect the electricity cable [18] to an adequate supply main.
- To switch on the tool, switch the switch button (ON) to the position I.
- To switch off the tool, switch the switch button (OFF) to the position 0.

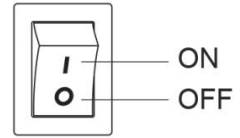

4. MAINTENANCE AND STORAGE

CAUTION!

To ensure proper functioning of the machine, it is necessary to have it checked and adjusted by qualified personnel in an authorized service centre at least once a year.

Proper maintenance is essential for safe, economic and trouble-free operation of the machine.

Failure to follow the maintenance instructions and safety precautions may cause serious injury or death. Always follow the procedures, safety precautions, recommended maintenance and recommended checks mentioned in this manual.

WARNING!

Prior to any work on the machine (maintenance, inspection, replacement of accessories, servicing) or before storing it, ALWAYS SWITCH THE ENGINE OFF, wait for all moving parts to stop and allow the machine to cool down. Prevent the engine from being started accidentally (disconnect the power unit from the mains).

THIS WARNING IS NOT REPEATED IN ANY FOLLOWING POINTS!

- Always make sure that all nuts and bolts are firmly tightened and make sure the machine is in good working order.
- Keep the machine in good condition, if necessary change warning and instruction labels on the machine.
- Always ensure that the ventilation openings are kept clear of debris.
- For safety reasons, replace worn or damaged parts. Only use original spare parts and accessories. Parts not tested and approved by the equipment manufacturer can cause unforeseeable damage.

CLEANING

- Clean the tool as soon as possible after each use with a slightly damp cloth or brush.
- Clean the covers, handles and especially the vents.

CAUTION!

Never spray the product with water or expose it to water.
Never use aggressive detergents or solvents for cleaning.

CARBON BRUSHES

In case of excessive sparking, have the carbon brushes checked only by an authorized service centre. Replacing the carbon brushes is associated with the necessary overall control of the tool.

Important! The carbon brushes should not be replaced by anyone but an authorized service centre.

STORAGE

- Store the machine out of reach of children.
- Turn the motor off and disconnect the mains plug if the machine is not used.
- Allow let the machine to cool down before storage.
- Do not store the machine a long time in direct sunlight.
- Replace worn or damaged parts for safety.
- Store machine in a clean, dry, dark and frost-free place, protected from dust and out of reach of children. The ideal storage temperature is between 5 and 30°C.

- Use the original packaging to storage whenever possible.
- Cover unit with a suitable protective cover that does not retain moisture. Do not use sheet plastic as a dust cover. A nonporous cover will trap moisture around the machine, promoting rust and corrosion.

TRANSPORT

Turn the motor off and disconnect the mains plug. When transporting, be careful not to drop, or otherwise shock the machine. For transport, the machine has to be fixed against slipping and tipping over. Do not place objects on the machine.

5. TROUBLESHOOTING

CAUTION!

You cannot rectify disorders that require more intervention yourself. If you're unable to rectify the fault using the corrective measures described below, contact a specialist garage, preferably an authorized service centre. Improper handling can cause damage or serious injuries.

Problem	Corrective action
An odour or smoke appeared after the first start-up	This is not a defect, but a normal occurrence. This occurrence disappears after a few minutes of operation.
Compressor did not start	Check the electrical connection (connection cable, socket, plug, fuses).
	The ambient temperature is lower than 5°C (At lower temperatures, the compressor may not switch on)
The engine runs, but there is no pressure from the compressor, the pressure gauge does not respond.	Check for proper nozzle/adaptor assembly.
	Try pushing longer. The pressure gauge shows the pressure only if the pressure inside the connected object exceeds the ambient pressure
	Make sure the pressurized item has no holes.
	Check that there is no damage to the air gun, pressure hose, quick couplings and nozzles. In the event of damage, replace the part.
The device is overheating	Be careful not to exceed the equipment's allowed working time (1.5 minutes of work every 10 minutes).

6. DISPOSAL



Electrical products should not be discarded with household products. According to the European Directive 2012/19/EC on waste electrical and electronic equipment and its implementation into national law, electrical products used must be collected separately and disposed of at collection points provided for this purpose. Talk with your local authorities or dealer for advice on recycling.

7. DECLARATION OF CONFORMITY



BUILDER SAS

**ZI, 32 rue, Aristide Bergès – 31270 Cugnaux - France
Tel: +33 (0)5.34.502.502 Fax: +33 (0)5.34.502.503**

**States that the designated below machine:
PORTABLE COMPRESSOR
RACCV8B**

Serial number: 20250110476-20250111975

Developed, designed and manufactured in accordance with the requirements of directives:
Machinery Directive 2006/42/EC
EMC Directive 2014/30/EC
ROHS Directive (EU)2015/863 amending 2011/65/EU

Also meets the following standards

EN 62841-1: 2015+A11:2022
EN 1012-1: 2010
AfPS GS 2019: 01 PAK
EK9-BE-103(V1): 2023
EN IEC 55014-1:2021;
EN IEC 55014-2:2021;
EN IEC 61000-3-2:2019/A1: 2021
EN 61000-3-3: 2013/A1:2019

Cugnaux, 01/01/2025

Philippe MARIE/PDG

Responsible of the technical file: Mr Olivier PATRIARCA

8. WARRANTY

The manufacturer guarantees the product against defects in material and workmanship for a period of 2 years from the date of the original purchase. It can be extended by one year if the user subscribes to website of myswap. The warranty only applies if the product is for household use. The warranty does not cover breakdowns due to normal wear and tear.

The manufacturer agrees to replace parts identified as defective by the designated distributor. The manufacturer does not accept responsibility for the replacement of the machine, in whole or in part, and/or ensuing damage.

The warranty does not cover breakdowns due to:

- insufficient maintenance.
- abnormal assembly, adjustment or operations of the product.
- parts subject to normal wear and tear.

The warranty does not extend to:

- shipping and packaging costs.
- using the tool for a purpose other than that for which it was designed.
- the use and maintenance of the machine done in a manner not described in the user manual.

Due to our policy of continuous product improvement, we reserve the right to alter or change specifications without notice. Consequently, the product may be different from the information contained therein, but a modification will be undertaken without notice if it is recognized as an improvement of the preceding characteristic.

READ THE MANUAL CAREFULLY BEFORE USING THE MACHINE.

When ordering spare parts, please indicate the part number or code, you can find this in the spare parts list in this manual. Keep the purchase receipt; without it, the warranty is invalid. To help you with your product, we invite you to contact us by phone or via our website:

+33 (0)9.70.75.30.30

<https://services.swap-europe.com/contact>

You must create a "ticket" via the web platform.

- Register or create your account.
- Indicate the reference of the tool.
- Choose the subject of your request.
- Describe your problem.



Attach these files: invoice or sales receipt, photo of the identification plate (serial number), photo of the part you need (for example: pins on the transformer plug which are broken).

9. PRODUCT FAILURE

WHAT TO DO IF MY MACHINE BREAKS DOWN?

If you bought your product in a store:

- Make sure that your machine is complete with all accessories supplied, and clean! If this is not the case, the repairer will refuse the machine.
- Go to the store with the complete machine and with the receipt or invoice.

If you bought your product on a website:

- Make sure that your machine is complete with all accessories supplied, and clean! If this is not the case, the repairer will refuse the machine.
- Create a SWAP-Europe service ticket on the site: <https://services.swap-europe.com> When making the request on SWAP-Europe, you must attach the invoice and the photo of the nameplate (serial number).

Contact the repair station to make sure it is available before dropping off the machine.

Go to the repair station with the complete machine packed, accompanied by the purchase invoice and the station support sheet downloadable after the service request is completed on the SWAP-Europe site

Please keep your original packaging to allow for after-sales service returns or pack your machine with a similar cardboard box of the same dimensions.

For any question concerning our after-sales service you can make a request on our website <https://services.swap-europe.com>

Our hotline remains available at +33 (9) 70 75 30 30.



10. WARRANTY EXCLUSIONS

THE WARRANTY DOES NOT COVER:

- Start-up and setting up of the product.
- Damage resulting from normal wear and tear of the product.
- Damage resulting from improper use of the product.
- Damage resulting from assembly or start-up not in accordance with the user manual.
- Periodic and standard maintenance events.
- Actions of modification and dismantling that directly void the warranty.
- Products whose original authentication marking (brand, serial number) has been degraded, altered or withdrawn.
- Replacement of consumables.
- The use of non-original parts.
- Breakage of parts following impacts or projections.
- Accessories breakdowns.
- Defects and their consequences linked to any external cause.
- Loss of components and loss due to insufficient screwing.
- Cutting components and any damage related to the loosening of parts.
- Overload or overheating.
- Poor power supply quality: faulty voltage, voltage error, etc.
- Damages resulting from the deprivation of enjoyment of the product during the time necessary for repairs and more generally the costs related to the immobilization of the product.
- The costs of a second opinion established by a third party following an estimate by a SWAP-Europe repair station
- The use of a product which would show a defect or a breakage which was not the subject of an immediate report and/or repair with the services of SWAP-Europe.
- Deterioration linked to transport and storage*.

* In accordance with transport legislation, damage related to transport must be declared to carriers within 48 hours maximum after observation by registered letter with acknowledgement of receipt. This document is a supplement to your notice, a non-exhaustive list.

Attention: all orders must be checked in the presence of the delivery person. In case of refusal by the delivery person, it you must simply refuse the delivery and notify your refusal.

Reminder: the reserves do not exclude the notification by registered letter with acknowledgement within 72 hours.

Information:

Thermal devices must be wintered each season (service available on the SWAP-Europe site). Batteries must be charged before being stored.



BUILDER SAS
32 rue Aristide Bergès - Z.I. du Casque - 31270 Cugnaux - France
MADE IN PRC